

For Lease

CVS Center

909 S Central Ave., Compton, CA 90220



Property Highlights

- Last available space 1,040 sq ft
- Anchored by a high volume CVS Pharmacy
- Located at the SWC of Central Ave. & Alondra Blvd., two of Los Angeles County's premier thoroughfares
- Other national co-tenants include Subway, Liberty Tax, and Cricket Wireless
- Dense, infill residential demographics
- Monument signage available
- High daytime population with approximately 10,058 workers in a 1 mile radius

Demographic Highlights

2017 Estimates	1-Mile	2-Mile	3-Mile
Population	27,668	88,823	226,758
Avg. HH Income	\$63,153	\$63,388	\$63,170

For more information, contact:

Daniel Firtel | Managing Director

T) 888-301-1888 x 3

E) dfirtel@argentretailadvisors.com

DRE License #01415261

Frank Magana | Director

T) 888-301-1888 x 7

E) fmagana@argentretailadvisors.com

DRE License #01866952

Terry Bortnick | President

T) 888-301-1888 x 2

E) tbortnick@argentretailadvisors.com

DRE License #01005344



Note: While the information contained herein is from sources deemed reliable and is believed to be correct, it is not in any way warranted or guaranteed by Argent Retail Advisors.

For Lease

CVS Center

909 S Central Ave., Compton, CA 90220

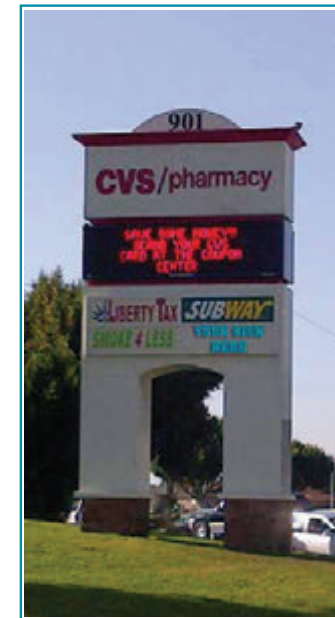
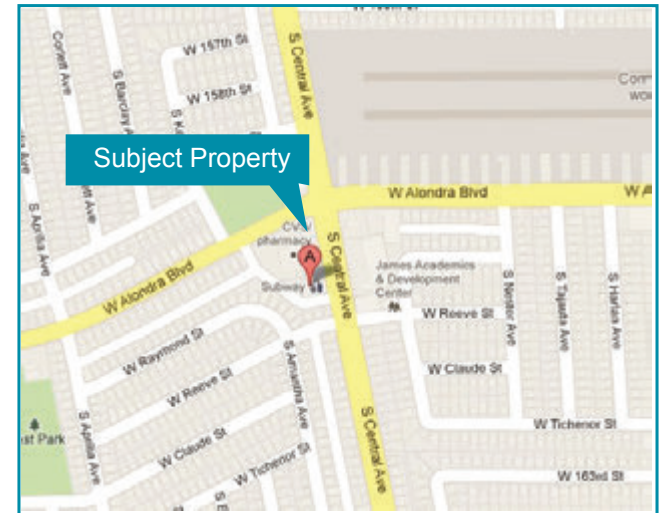
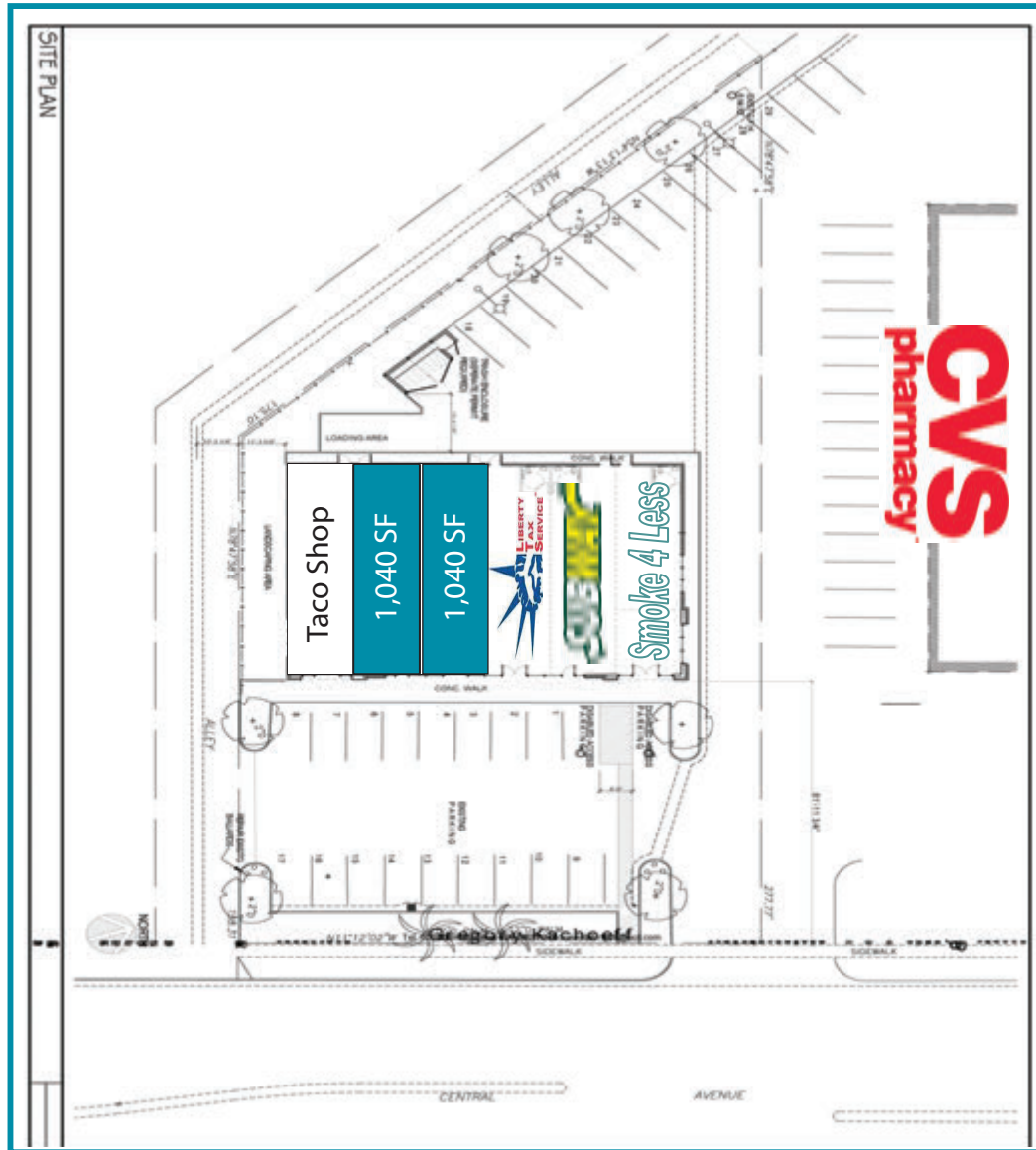

For more information, contact:

Daniel Firtel | Managing Director
T) 888-301-1888 x 3
E) dfirtel@argentretailadvisors.com
DRE License #01415261

Frank Magana | Director
T) 888-301-1888 x 7
E) fmagana@argentretailadvisors.com
DRE License #01866952

Terry Bortnick | President
T) 888-301-1888 x 2
E) tbortnick@argentretailadvisors.com
DRE License #01005344

Argent
RETAIL ADVISORS

Note: While the information contained herein is from sources deemed reliable and is believed to be correct, it is not in any way warranted or guaranteed by Argent Retail Advisors.